

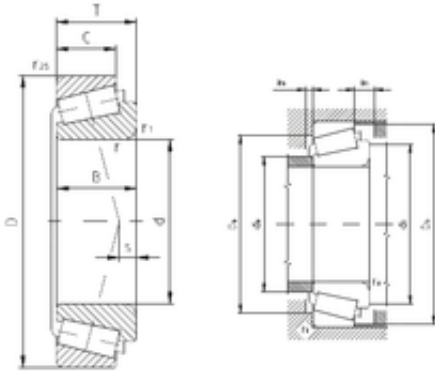

IJK BEARING COMPANY

35 mm x 60 mm x 16,764 mm ZVL K-L68149/K-L68111 tapered roller bearings



Bearing No. K-L68149/K-L68111

K-L68149/K-L68111 Bearing 2D drawings and 3D CAD models

Size	35x60x15.875 mm
Bore Diameter	35 mm
Outer Diameter	60 mm
Width	15,875 mm
d	35 mm
D	60 mm
T	15,875 mm
B	16,764 mm
C	11,938 mm
r min.	4,75 mm
r1 min.	3,56 mm
r2 min.	1,3 mm
S	2,5 mm
da max	40 mm
Da min	52 mm
Da max.	54 mm
db min	46 mm
Db min.	56 mm
ra max.	3 mm
rb max.	1 mm
Weight	0,176 Kg
Basic dynamic load rating (C)	34,4 kN
Basic static load rating (C0)	44 kN
(Grease) Lubrication Speed	6 300 r/min
(Oil) Lubrication Speed	8 400 r/min



IJK BEARING COMPANY

Calculation factor (e)	0,42
Calculation factor (Y)	1,4