

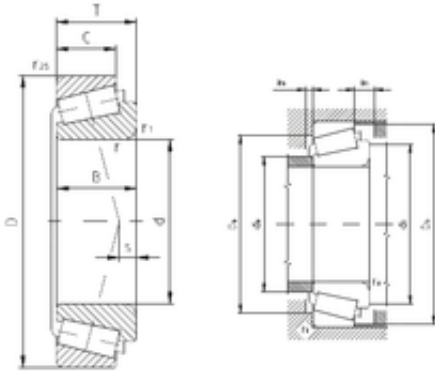

IJK BEARING COMPANY

41 mm x 67,975 mm x 18 mm ZVL K-LM300849/K-LM300811 tapered roller bearings



Bearing No. K-LM300849/K-LM300811

K-LM300849/K-LM300811 Bearing 2D drawings and 3D CAD models

Size	41x67.975x17.5 mm
Bore Diameter	41 mm
Outer Diameter	67,975 mm
Width	17,5 mm
d	41 mm
D	67,975 mm
T	17,5 mm
B	18 mm
C	13,5 mm
r min.	3,6 mm
r1 min.	3,6 mm
r2 min.	1,5 mm
S	3,6 mm
da max	45 mm
Da min	58 mm
Da max.	61 mm
db min	52 mm
Db min.	63 mm
ra max.	0,6 mm
rb max.	1,5 mm
Weight	0,23 Kg
Basic dynamic load rating (C)	47,3 kN
Basic static load rating (C0)	59,6 kN
(Grease) Lubrication Speed	5 300 r/min
(Oil) Lubrication Speed	7 100 r/min



IJK BEARING COMPANY

Calculation factor (e)	0,35
Calculation factor (Y)	1,7